

FAN COIL UNIT

(WALL MOUNTED TYPE)



TRUST AIR CONDITIONING EQUIPMENT CO.
Prepared By: Engineering & R & D Department.

Introduction

TMFCW fan coil is a kind of newly designed fan coil units, which is mounted on the wall. It has two kinds of body, both have 3-way valve inside the body. In addition, it has panels of different color can be optional.

TMFCW series fan coil is designed and manufactured on the base of fully adoption advanced technology. The acute and thin body makes it save a lot of space and easy for installation. Quality materials and state-of-the-art technology ensure optimal performance with virtually imperceptible noise levels and keep running smoothly.

TRUST TMFCW series fan coil unit has been tested by national AC quality supervise testing center, as low noise level, high efficiency, stable operation and low power consumption make it as the advanced production in the world,. Due to their reduced dimensions and pleasing design, these units are ideally suited for Commercial and Residential environments.

TRUST New Codes:

Old Model	New Code
TMFCW-300V	RB02-TMW1Y03R2R/1N
TMFCW-400V	RB02-TMW1Y04R2R/1N
TMFCW-500V	RB02-TMW1Y05R2R/1N
TMFCW-600V	RB02-TMW1Y06R2R/1N

توجه:

شرکت تراست حق تغییر مشخصات دستگاه ها را در جهت بهبود و ارتقای کیفیت برای خود محفوظ می دارد.

Indoor Unit

1. Features	5
2. Specification	6
3. Dimensions.....	8
4. Service Spaces	9
5. Wiring Diagram.....	9
6. Capacity Tables	10
7. Electric Characteristics	13
8. Sound Levels.....	13
9. Exploded View	14
10. Operation Limits.....	16

1. Features



1. LED display.
2. Big and small panels have different colors for choose: white and brown for big panel, blue and brown for small panel, and the other colors can be customized according to the customers' demands.
3. Multi-connection outlet pipe method: left\right\rear, satisfy the need of different rooms.

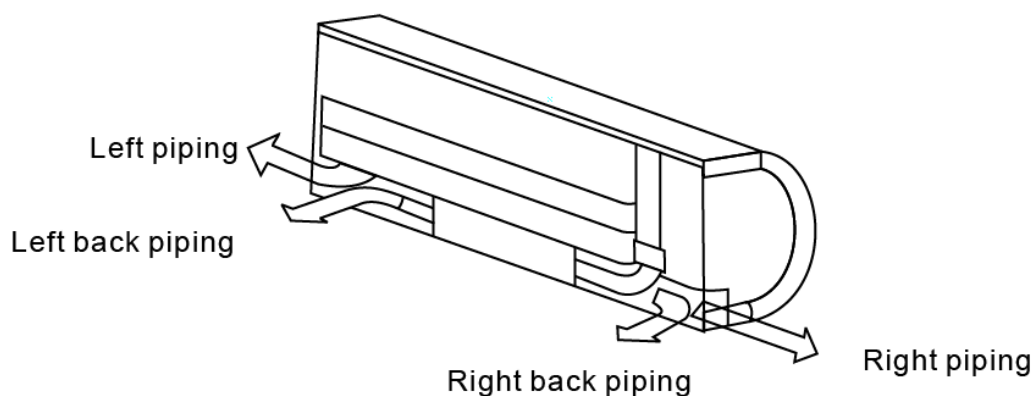

4. Built-in the electromagnetic 3-way valve.
5. Adopt new type installation plate, easy for installation and stable.
6. Three air flow speed: high、 middle and low, double air guides.
7. Low noise, creates quite and comfortable environment.
8. Air cleaning equipment and the high efficiency filter, keep the air fresh.
9. The same controller as DX system, Remote control is standard, wire control, central control can be optional.
10. Copper tube/aluminum fin coils
11. ON/OFF terminal for remote control
12. Reserve control port for water pump & water level switch in the PCB
13. Accessorial electric heater, carbanion filter, electrostatic dust wipe off

2. Specification

Type		TMFCW-300V	TMFCW-400V	
Power Source	V-Ph-Hz	220-230V~, 1Ph, 50Hz		
Airflow	CFM	300	400	
	m ³ /h	510	680	
Cooling Capacity	W	2638	3077	
	Btu/h	9000	10500	
Heating Capacity	W	3693	4338	
	Btu/h	12600	14800	
Rated Input	W	40	44	
Rated Current	A	0.18	0.20	
Indoor sound level (sound pressure level)	dB(A)	35/32/27	35/32/27	
Water flow	LPH	454	529	
Water resistance	kPa	18	22	
Indoor Coil	Number of rows		2	2
	Tube pitch(a)x row pitch(b)	mm	21×13.37	21×13.37
	Fin spacing	mm	1.5	1.5
	Fin type		hydrophilic aluminium	
	Tube outside dia. and type	mm	Φ7, bare tube	
	Coil length x height x width	mm	635×315×26.74	
	Number of circuits		5	5
Indoor motor fan	Model		YDK15-4	YDK15-4
	Brand		Weilling	Weilling
	Input	W	41/33/27	41/33/27
	Capacitor	uF	1.2	1.2
	Speed	r/min	1000/860/730	1000/860/730
Indoor unit	Dimension (W×H×D)	mm	915 x210x290	
	Packing (W×H×D)	mm	1020X300X385	
	Net/Gross weight	kg	12/16	12/16
Control mode		Remote controller (standard) (R51/E)		
Pipe	Water-inlet pipe	mm(inch)	19.1(3/4)	19.1(3/4)
	Water-return pipe	mm(inch)	19.1(3/4)	19.1(3/4)
	Condensation water-outlet pipe	mm	Φ20	Φ20

Remark:

- All performance data above is based upon 0Pa ambient static pressure.
- Cooling capacity test condition: air inlet Temp. : 27DB°C/19WB°C, water inlet Temp. 7°C, water Temp. difference 5°C
- Heating capacity test condition: Air inlet Temp. 20DB°C, water inlet Temp. 50 DB°C, the volume of air and water is same as cooling.
- Noise level is tested in full-anechoic room.

Type			TMFCW-500V	TMFCW-600V	
Power Source		V-Ph-Hz	220-230V~, 1Ph, 50Hz		
Airflow		CFM	500	600	
		m ³ /h	850	1020	
Cooling Capacity		W	4074	4455	
		Btu/h	13900	15200	
Heating Capacity		W	5686	6300	
		Btu/h	19400	21500	
Rated Input		W	50	60	
Rated Current		A	0.23	0.27	
Indoor sound level (sound pressure level)		dB(A)	38/35/31	38/35/31	
Water flow		LPH	701	766	
Water resistance		kPa	26	29	
Indoor Coil	Number of rows		2	2	
	Tube pitch(a)x row pitch(b)		mm	21×13.37	21×13.37
	Fin spacing		mm	1.5	1.5
	Fin type			hydrophilic aluminium	
	Tube outside dia. and type		mm	Φ7, bare tube	
	Coil length x height x width		mm	785×315×26.74	
	Number of circuits			7	7
Indoor fan motor	Model		YDK18-4		
	Brand		Weilling		
	Input		W	44/42/39	
	Capacitor		uF	1	1.5
	Speed		r/min	1030/980/880	
Indoor unit	Dimension (W×H×D)		mm	1070 x210x315	
	Packing (W×H×D)		mm	1180X300X410	
	Net/Gross weight		kg	15/19	
Control mode			Remote controller (standard) (R51/E)		
Pipe	Water-inlet pipe		mm(inch)	19.1(3/4)	19.1(3/4)
	Water-return pipe		mm(inch)	19.1(3/4)	19.1(3/4)
	Condensation water-outlet pipe		mm	Φ20	Φ20

Remark:

1. All performance data above is based upon 0Pa ambient static pressure.
2. Cooling capacity test condition: air inlet Temp. : 27DB°/19WB°C, water inlet Temp. 7°C, water Temp. difference 5°C
3. Heating capacity test condition: Air inlet Temp. 20DB°C, water inlet Temp. 50 DB°C, the volume of air and water is same as cooling.
4. Noise level is tested in full-anechoic room.

3. Dimensions

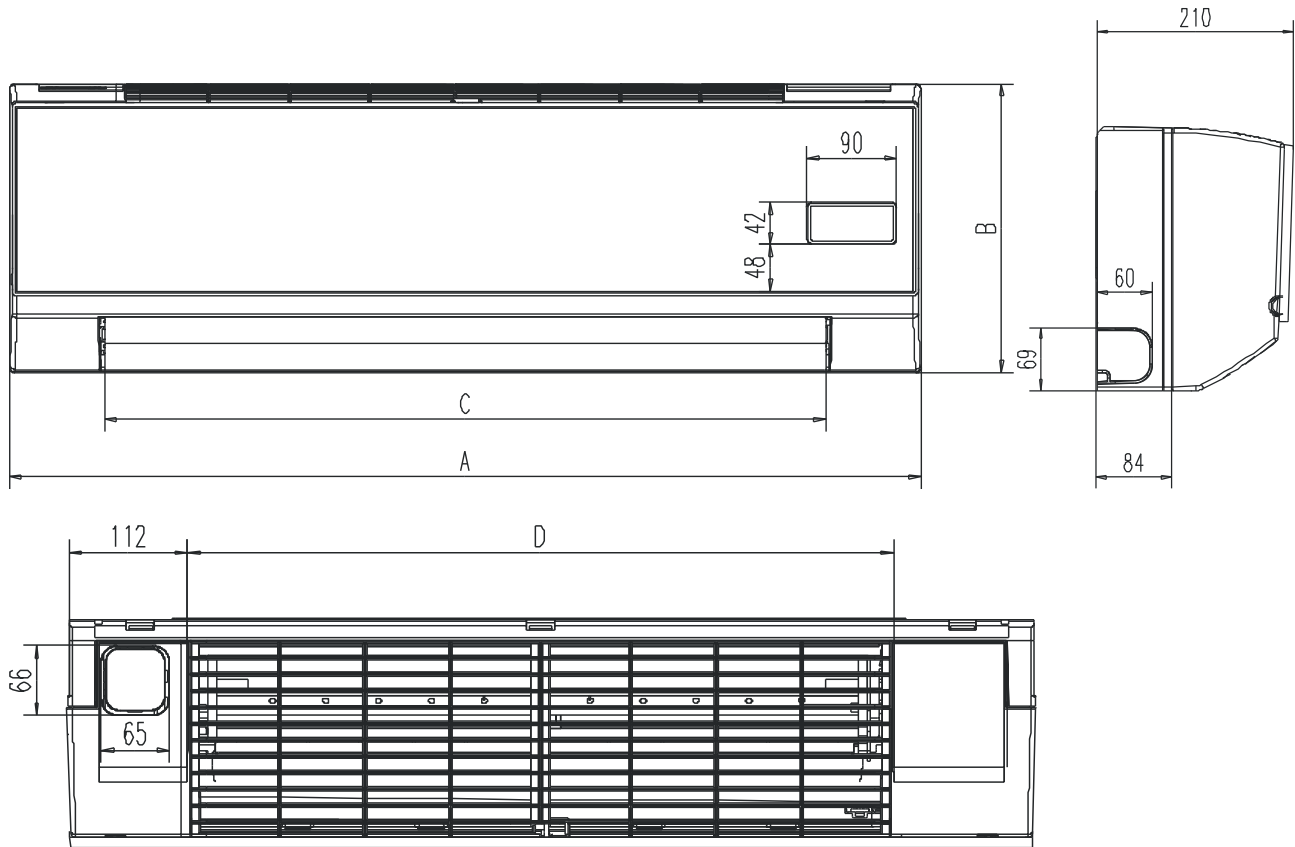

Model	TMFCW-300V	TMFCW-400V	TMFCW-500V	TMFCW-600V
A	915	915	1070	1070
B	290	290	315	315
C	725	725	885	885
D	670	670	815	815

4. Service Spaces

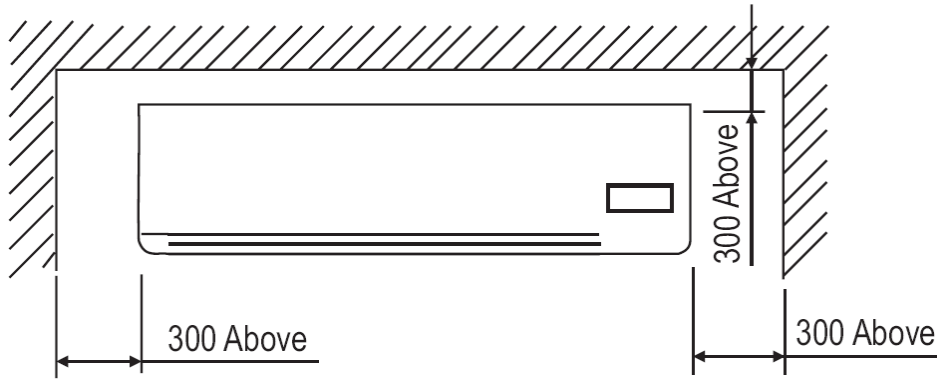

5. Wiring Diagram

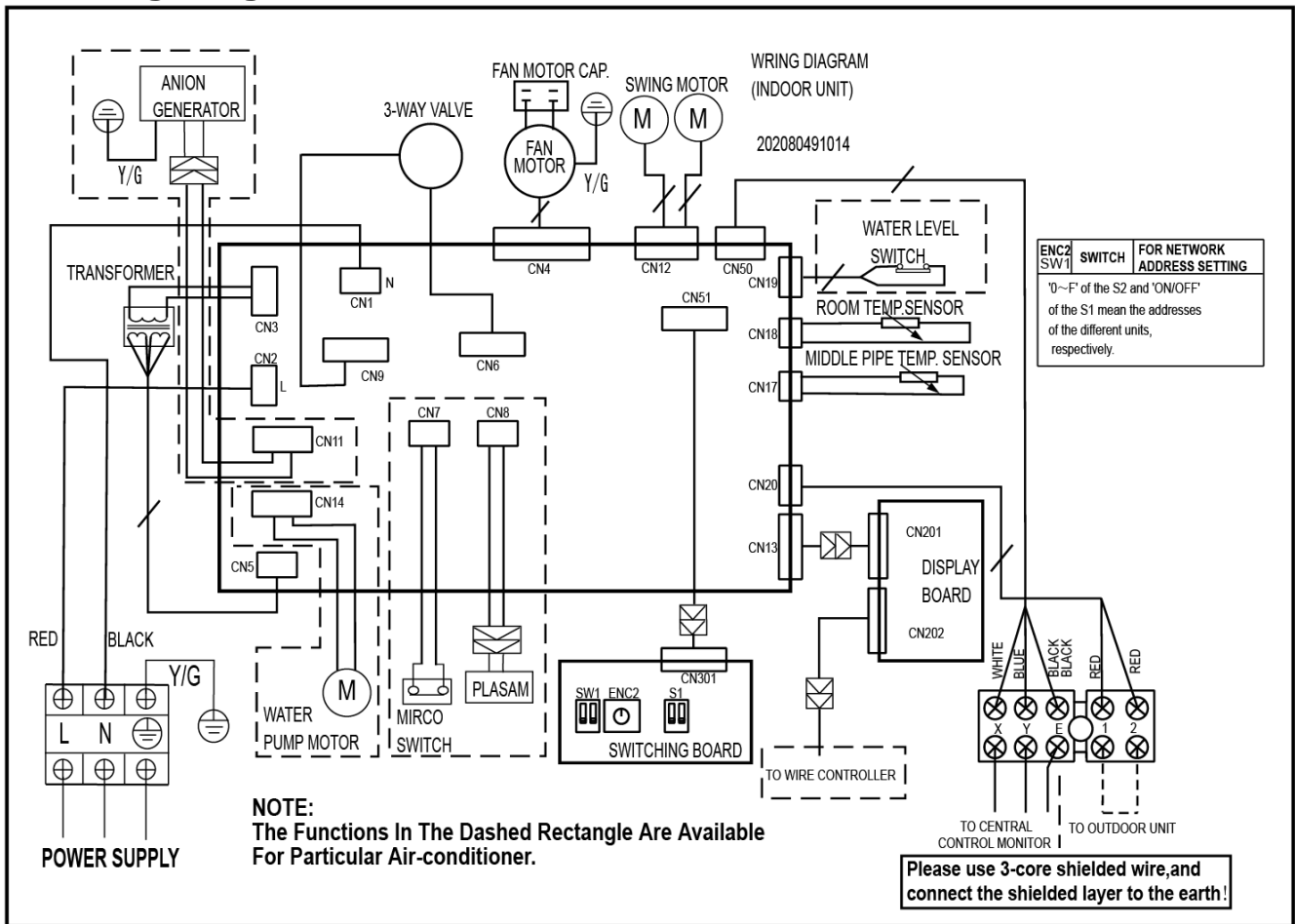

6. Capacity Tables

Cooling Capacity Table:

Model	Speed	Air On FCU		Water		Delta Water Temp.	ESP	Speed of Fan	Air Flow	Air Off FCU		Capacity		Water Flow	Water Pressure Drop	Weight	Input	
		DB	WB	EWT	LWT					DB	WB	Total	Sens.				VE/CE	PWR
		°C	°C	°C	°C	°C	Pa	rpm	m ³ /h	°C	°C	kW	kW	m ³ /h	kPa	kg	W	nos.
TMFCW-300V	High	26.7	19.4	7	12	5	0	1000	510	14.6	13.9	2.66	1.98	0.46	18.70	12	41	1
				5.5	14.5	9	0	1000	510	17.6	16.6	1.47	1.09	0.23	8.50	12	41	1
		27	19	7	12	5	0	1000	510	14.6	13.6	2.54	2.04	0.44	18.00	12	41	1
				5.5	14.5	9	0	1000	510	17.1	16.2	1.39	1.12	0.22	8.30	12	41	1
		29	21	7	12	5	0	1000	510	15	14	3.33	2.55	0.57	22.30	12	41	1
				5.5	14.5	9	0	1000	510	18.4	17.4	1.83	1.40	0.29	9.60	12	41	1
	Mid	26.7	19.4	7	12	5	0	860	432	14.2	13.2	2.24	1.64	0.39	16.90	12	33	1
				5.5	14.5	9	0	860	432	17	16.2	1.23	0.90	0.19	7.80	12	33	1
		27	19	7	12	5	0	860	432	14	13.1	2.04	1.50	0.35	16.10	12	33	1
				5.5	14.5	9	0	860	432	16.9	16	1.12	0.82	0.18	7.50	12	33	1
		29	21	7	12	5	0	860	432	14.2	13.3	2.76	1.86	0.47	19.00	12	33	1
				5.5	14.5	9	0	860	432	18	17.1	1.52	1.02	0.24	8.80	12	33	1
Low	26.7	19.4	7	12	5	0	730	346	13.6	12.7	2.01	1.57	0.34	15.80	12	27	1	
			5.5	14.5	9	0	730	346	17	16	1.11	0.87	0.17	7.10	12	27	1	
	27	19	7	12	5	0	730	346	13.8	12.9	2.50	1.68	0.43	17.80	12	27	1	
			5.5	14.5	9	0	730	346	16.7	15.7	1.38	0.92	0.21	8.00	12	27	1	
	29	21	7	12	5	0	730	346	13.5	12.6	2.32	1.54	0.40	17.20	12	27	1	
			5.5	14.5	9	0	730	346	17.6	16.7	1.28	0.85	0.20	8.10	12	27	1	
TMFCW-400V	High	26.7	19.4	7	12	5	0	1000	680	14.6	13.9	3.02	2.70	0.52	22.40	12	41	1
				5.5	14.5	9	0	1000	680	17.6	16.6	1.66	1.49	0.26	10.20	12	41	1
		27	19	7	12	5	0	1000	680	14.6	13.6	3.09	2.76	0.53	22.00	12	41	1
				5.5	14.5	9	0	1000	680	17.1	16.2	1.60	1.31	0.25	10.00	12	41	1
		29	21	7	12	5	0	1000	680	15	14	3.94	3.10	0.68	26.50	12	41	1
				5.5	14.5	9	0	1000	680	18.4	17.4	2.17	1.71	0.34	15.80	12	41	1
	Mid	26.7	19.4	7	12	5	0	860	557	14.2	13.2	2.75	2.05	0.47	21.00	12	33	1
				5.5	14.5	9	0	860	557	17	16.2	1.51	1.13	0.24	9.60	12	33	1
		27	19	7	12	5	0	860	557	14	13.1	2.62	2.12	0.45	20.40	12	33	1
				5.5	14.5	9	0	860	557	16.9	16	1.44	1.17	0.23	9.70	12	33	1
		29	21	7	12	5	0	860	557	14.2	13.3	3.44	2.66	0.59	24.10	12	33	1
				5.5	14.5	9	0	860	557	18	17.1	1.89	1.46	0.30	11.10	12	33	1
Low	26.7	19.4	7	12	5	0	730	458	13.6	12.7	2.38	1.76	0.41	19.80	12	27	1	
			5.5	14.5	9	0	730	458	17	16	1.31	0.97	0.21	9.20	12	27	1	
	27	19	7	12	5	0	730	458	13.8	12.9	2.27	1.81	0.39	18.50	12	27	1	
			5.5	14.5	9	0	730	458	16.7	15.7	1.25	1.00	0.20	8.80	12	27	1	
	29	21	7	12	5	0	730	458	13.5	12.6	2.96	2.00	0.51	22.40	12	27	1	
			5.5	14.5	9	0	730	458	17.6	16.7	1.63	1.10	0.26	10.30	12	27	1	
TMFCW-500V	High	26.7	19.4	7	12	5	0	1030	850	14.6	13.9	3.99	3.28	0.69	26.80	15	44	1
				5.5	14.5	9	0	1030	850	17.6	16.6	2.19	1.80	0.35	11.50	15	44	1
		27	19	7	12	5	0	1030	850	14.6	13.6	4.07	3.35	0.70	26.00	15	44	1
				5.5	14.5	9	0	1030	850	17.1	16.2	2.24	1.84	0.35	10.90	15	44	1
		29	21	7	12	5	0	1030	850	15	14	5.09	3.76	0.87	31.50	15	44	1
				5.5	14.5	9	0	1030	850	18.4	17.4	2.80	2.07	0.44	18.20	15	44	1
	Mid	26.7	19.4	7	12	5	0	980	751	14.2	13.2	3.66	2.98	0.63	25.30	15	42	1
				5.5	14.5	9	0	980	751	17	16.2	2.01	1.64	0.32	10.70	15	42	1
		27	19	7	12	5	0	980	751	14	13.1	3.73	3.04	0.64	24.80	15	42	1
				5.5	14.5	9	0	980	751	16.9	16	2.05	1.67	0.32	10.20	15	42	1
		29	21	7	12	5	0	980	751	14.2	13.3	4.66	3.41	0.80	30.00	15	42	1
				5.5	14.5	9	0	980	751	18	17.1	2.56	1.88	0.40	17.10	15	42	1
Low	26.7	19.4	7	12	5	0	880	614	13.6	12.7	3.18	2.54	0.55	22.50	15	39	1	
			5.5	14.5	9	0	880	614	17	16	1.75	1.40	0.28	10.00	15	39	1	
	27	19	7	12	5	0	880	614	13.8	12.9	3.24	2.59	0.56	21.50	15	39	1	
			5.5	14.5	9	0	880	614	16.7	15.7	1.78	1.42	0.28	9.50	15	39	1	
	29	21	7	12	5	0	880	614	13.5	12.6	4.03	2.91	0.69	26.80	15	39	1	
			5.5	14.5	9	0	880	614	17.6	16.7	2.56	1.88	0.40	17.10	15	42	1	

Model	Speed	Air On FCU		Water		Delta Water Temp.	ESP	Speed of Fan	Air Flow	Air Off FCU		Capacity		Water Flow	Water Pressure Drop	Weight VE/CE	Input	
		DB	WB	EWT	LWT					DB	WB	Total	Sens.				PWR	Fan Motors
		°C	°C	°C	°C	°C	Pa	rpm	m ³ /h	°C	°C	kW	kW	m ³ /h	kPa	kg	W	nos.
TMFCW-600V	High	26.7	19.4	5.5	14.5	9	0	880	614	17.6	16.7	2.22	1.60	0.35	11.40	15	39	1
				7	12	5	0	1030	1020	14.6	13.9	4.37	3.65	0.75	30.00	15	44	1
		27	19	5.5	14.5	9	0	1030	1020	17.6	16.6	2.40	2.01	0.38	12.50	15	44	1
				7	12	5	0	1030	1020	14.6	13.6	4.45	3.73	0.77	29.00	15	44	1
				5.5	14.5	9	0	1030	1020	17.1	16.2	2.45	2.05	0.39	12.20	15	44	1
				7	12	5	0	1030	1020	15	14	5.60	4.19	0.96	34.50	15	44	1
	29	21	5.5	14.5	9	0	1030	1020	18.4	17.4	3.08	2.30	0.48	16.90	15	44	1	
			7	12	5	0	980	930	14.2	13.2	4.10	3.40	0.71	29.00	15	42	1	
			5.5	14.5	9	0	980	930	17	16.2	2.26	1.87	0.36	12.20	15	42	1	
			7	12	5	0	980	930	14	13.1	4.18	3.48	0.72	28.10	15	42	1	
	Mid	26.7	19.4	5.5	14.5	9	0	980	930	16.9	16	2.30	1.91	0.36	11.90	15	42	1
				7	12	5	0	980	930	14.2	13.3	5.24	3.90	0.90	33.00	15	42	1
		27	19	5.5	14.5	9	0	980	930	18	17.1	2.88	2.15	0.45	15.80	15	42	1
				7	12	5	0	880	790	13.6	12.7	3.67	2.99	0.63	27.50	15	39	1
				5.5	14.5	9	0	880	790	17	16	2.02	1.64	0.32	11.50	15	39	1
				7	12	5	0	880	790	13.8	12.9	3.74	3.06	0.64	27.40	15	39	1
	29	21	5.5	14.5	9	0	880	790	16.7	15.7	2.06	1.68	0.32	11.00	15	39	1	
			7	12	5	0	880	790	13.5	12.6	4.67	3.43	0.80	30.00	15	39	1	
			5.5	14.5	9	0	880	790	17.6	16.7	2.57	1.89	0.40	13.40	15	39	1	
			7	12	5	0	880	790	13.5	12.6	4.67	3.43	0.80	30.00	15	39	1	

Remark:

ESP: external static pressure; DB: dry bulb temp.; WB: wet bulb temp.; EWT: enter water temp.; LWT: leaving water temp.; PWR: power; nos: numbers. VE :vertical exposed type;

Heating Capacity:

Heating Capacity:

Model	Air flow volume (Hi)	Water temp. change	Air inlet temp. (21°C DB)																								
			Water inlet temp. (°C)																								
			35			40			45			50			55			60			65			70			
			Capacity	Water flow volume	Water pressure drop	Capacity	Water flow volume	Water pressure drop	Capacity	Water flow volume	Water pressure drop	Capacity	Water flow volume	Water pressure drop	Capacity	Water flow volume	Water pressure drop	Capacity	Water flow volume	Water pressure drop	Capacity	Water flow volume	Water pressure drop	Capacity	Water flow volume	Water pressure drop	Capacity
m³/h	°C	kW	m³/h	kPa	kW	m³/h	kPa	kW	m³/h	kPa	kW	m³/h	kPa	kW	m³/h	kPa	kW	m³/h	kPa	kW	m³/h	kPa	kW	m³/h	kPa		
TMFCW-300V	510	10	0.51	0.04	1.44	1.15	0.10	3.60	1.78	0.15	5.40	2.41	0.21	7.56	3.04	0.26	9.36	3.67	0.32	11.52	4.30	0.37	13.32	4.92	0.42	15.12	
		8	0.77	0.08	2.88	1.40	0.15	5.40	2.03	0.22	7.92	2.66	0.29	10.44	3.29	0.35	12.60	3.91	0.42	15.12	4.54	0.49	17.64	5.17	0.56	20.16	
		7	0.89	0.11	3.96	1.53	0.19	6.84	2.15	0.26	9.36	2.78	0.34	12.24	3.41	0.42	15.12	4.04	0.50	18.00	4.67	0.57	20.52	5.29	0.65	23.40	
		6	1.02	0.15	5.40	1.65	0.24	8.64	2.28	0.33	11.88	2.90	0.42	15.12	3.53	0.51	18.36	4.16	0.60	21.60	4.79	0.69	24.84	5.42	0.78	28.08	
		5	1.14	0.20	7.20	1.77	0.30	10.80	2.40	0.41	14.76	3.03	0.52	18.72	3.66	0.63	22.68	4.28	0.74	26.64	4.91	0.84	30.24	5.55	0.95	34.20	
TMFCW-400V	680	10	0.60	0.05	2.08	1.40	0.12	4.98	2.20	0.19	7.89	3.00	0.26	10.79	3.80	0.33	13.70	4.59	0.39	16.19	5.39	0.46	19.09	6.19	0.53	22.00	
		8	0.93	0.10	4.15	1.73	0.19	7.89	2.53	0.27	11.21	3.32	0.36	14.94	4.12	0.44	18.26	4.92	0.53	22.00	5.72	0.61	25.32	6.52	0.70	29.05	
		7	1.10	0.13	5.40	1.89	0.23	9.55	2.69	0.33	13.70	3.49	0.43	17.85	4.25	0.53	105.00	5.08	0.62	25.73	5.88	0.72	29.88	6.68	0.82	34.03	
		6	1.26	0.18	7.47	2.05	0.29	12.04	2.85	0.41	17.02	3.65	0.52	21.58	4.45	0.64	26.56	5.25	0.75	31.13	6.05	0.87	36.11	6.85	0.98	40.67	
		5	1.42	0.24	9.96	2.22	0.38	15.77	3.01	0.52	21.58	3.81	0.66	27.39	4.61	0.79	32.79	5.41	0.93	38.60	6.21	1.07	44.41	7.02	1.21	50.22	
TMFCW-500V	850	10	0.94	0.08	2.97	2.01	0.17	6.31	3.05	0.26	9.66	4.09	0.35	13.00	5.12	0.44	16.34	6.15	0.53	19.68	7.18	0.62	23.03	8.20	0.70	26.00	
		8	1.36	0.15	5.57	2.40	0.26	9.66	3.44	0.37	13.74	4.47	0.48	17.83	5.49	0.59	21.91	6.52	0.70	26.00	7.55	0.81	30.08	8.58	0.92	34.17	
		7	1.55	0.19	7.06	2.59	0.32	11.88	3.62	0.44	16.34	4.65	0.57	21.17	5.68	0.70	26.00	6.71	0.82	30.45	7.74	0.95	35.28	8.77	1.08	40.11	
		6	1.75	0.25	9.29	2.78	0.40	14.86	3.81	0.55	20.43	4.84	0.69	25.63	5.87	0.84	31.20	6.90	0.99	36.77	7.93	1.14	42.34	8.96	1.28	47.54	
		5	1.94	0.33	12.26	2.97	0.51	18.94	4.00	0.69	25.63	5.03	0.86	31.94	6.06	1.04	38.63	7.09	1.22	45.31	8.12	1.39	51.62	9.15	1.57	58.31	
TMFCW-600V	1020	10	1.06	0.09	3.22	2.29	0.20	7.16	3.50	0.30	10.74	4.70	0.40	14.32	5.90	0.51	18.26	7.09	0.61	21.84	8.29	0.71	25.42	9.49	0.82	29.36	
		8	1.54	0.17	6.09	2.75	0.30	10.74	3.59	0.42	15.04	5.15	0.55	19.69	6.35	0.68	24.34	7.54	0.81	29.00	8.74	0.94	33.65	9.94	1.07	38.31	
		7	1.77	0.22	7.88	2.98	0.37	13.25	4.18	0.51	18.26	5.37	0.66	23.63	6.57	0.81	29.00	7.77	0.95	34.01	8.96	1.10	39.38	10.16	1.25	44.75	
		6	2.00	0.29	10.38	3.20	0.46	16.47	4.40	0.63	22.55	5.60	0.80	28.64	6.79	0.97	34.73	7.99	1.14	40.81	9.19	1.32	47.26	10.39	1.49	53.34	
		5	2.23	0.38	13.60	3.43	0.59	21.12	4.62	0.79	28.28	5.82	1.00	35.80	7.02	1.21	43.32	8.22	1.41	50.48	9.42	1.62	58.00	10.62	1.83	65.51	

Heating capacity modification coefficient table:

Model	TMFCW-300V	TMFCW-400V	TMFCW-500V	TMFCW-600V
Mid-speed	0.88	0.89	0.9	0.9
Low-speed	0.75	0.75	0.76	0.75

7. Electric Characteristics

Model	Indoor Unit				Power Supply		IFM	
	Hz	Voltage	Min.	Max.	MCA	MFA	KW	FLA
TMFCW-300V	50	220-230V	209	252	0.19	15	0.015	0.185
TMFCW-400V	50	220-230V	209	252	0.2	15	0.015	0.185
TMFCW-500V	50	220-230V	209	252	0.24	15	0.018	0.19
TMFCW-600V	50	220-230V	209	252	0.33	15	0.018	0.19

Remark:

MCA: Min. Current Amps. (A)

MFA: Max. Fuse Amps. (A)

KW: Fan Motor Rated Output (kW)

FLA: Full Load Amps. (A)

IFM: Indoor Fan Motor

8. Sound Levels

Test condition

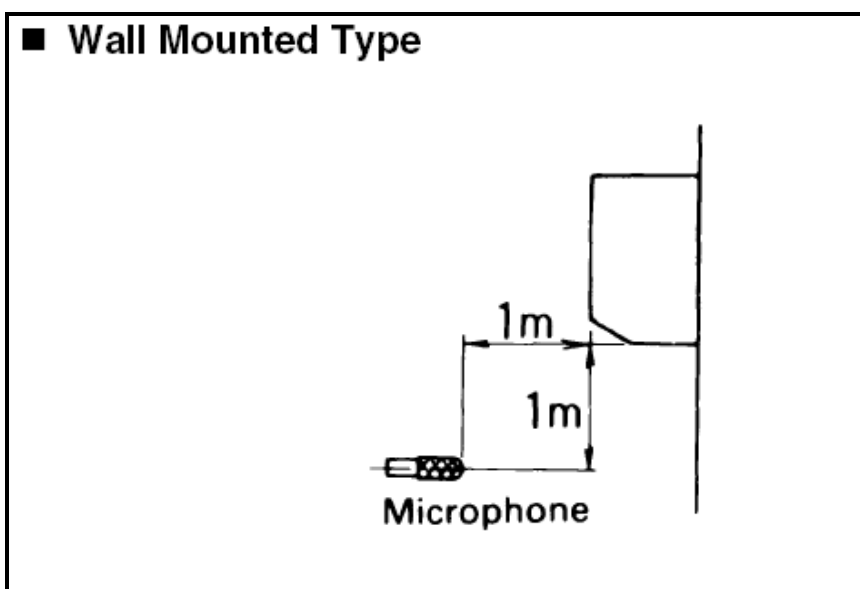

Unit Number	Model	Noise level under three speeds of fan (dB(A))		
		H	M	L
2	TMFCW-300	35	32	27
3	TMFCW-400	35	32	27
4	TMFCW-500	38	35	31
5	TMFCW-600	38	35	31

9. Exploded View

9.1 TMFCW-300V TMFCW-400V

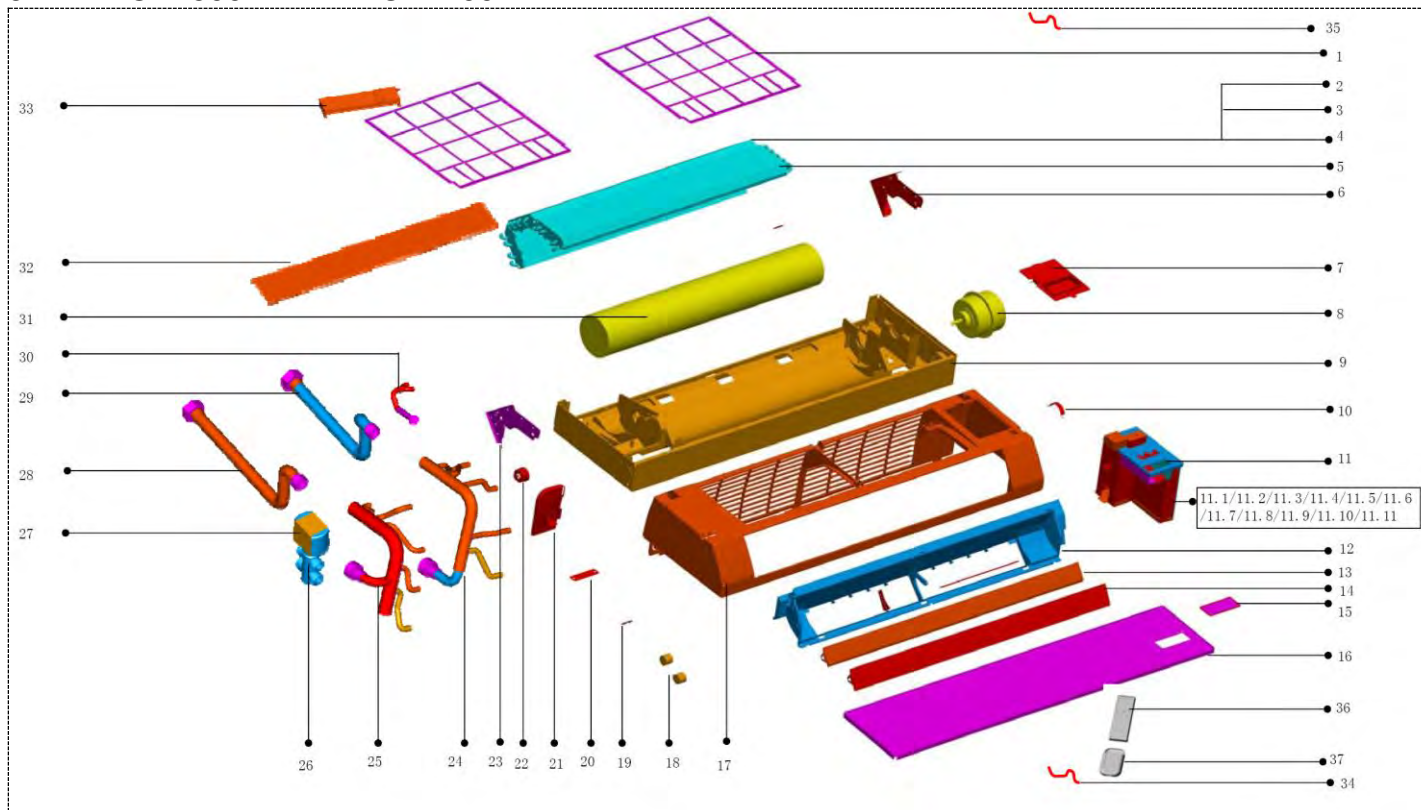

No.	Part Name	Quantity	No.	Part Name	Quantity
1	Filter	2	14	Louver	1
2	Evaporator I	1	15	Panel dalle	1
3	Evaporator II	1	16	Panel	1
4	Evaporator III	1	17	Panel frame ass'y	1
5	Coil temp sensor	1	18	Stepper motor	2
6	Evaporate connect board	1	19	Screw cover	3
7	Display board ass'y	1	20	Pipe clamp	1
8	Motor	1	21	Drainage pan	1
9	Base pan assembly	1	22	Bearing base	1
10	Motor spud	2	23	Evaporator left clapboard	1
11	E-part box ass'y	1	24	Water inlet pipe ass'y	1
11.1	Dial code switch box cover	1	25	Water outlet pipe ass'y	1
11.2	Electric control box seat	1	26	Three-way valve	1
11.3	E-Part box cover	1	27	Control wire for 3-Ways valve	1
11.4	Electric control box soleplate	1	28	Outlet screw pipe ass'y	1
11.5	Electric control box side board ass'y	1	29	Inlet screw pipe ass'y	1
11.6	Dial code switch board ass'y	1	30	Discharge valve	1
11.7	Main controller ass'y	1	31	Cross fan	1
11.8	Transformer	1	32	Base pan holder	1
11.9	Wire joint	1	33	Formaldehyde killer	1
11.10	Wire joint, 3p	1	34	Room Temperature Sensor Ass'y	1
11.11	Motor capacitor	1	35	Network matching wire	1
12	Air outlet frame mount ass'y	1	36	Remote controller	1
13	Louver board	1	37	Remote controller holder ass'y	1

9.2 TMFCW-500V TMFCW-600V

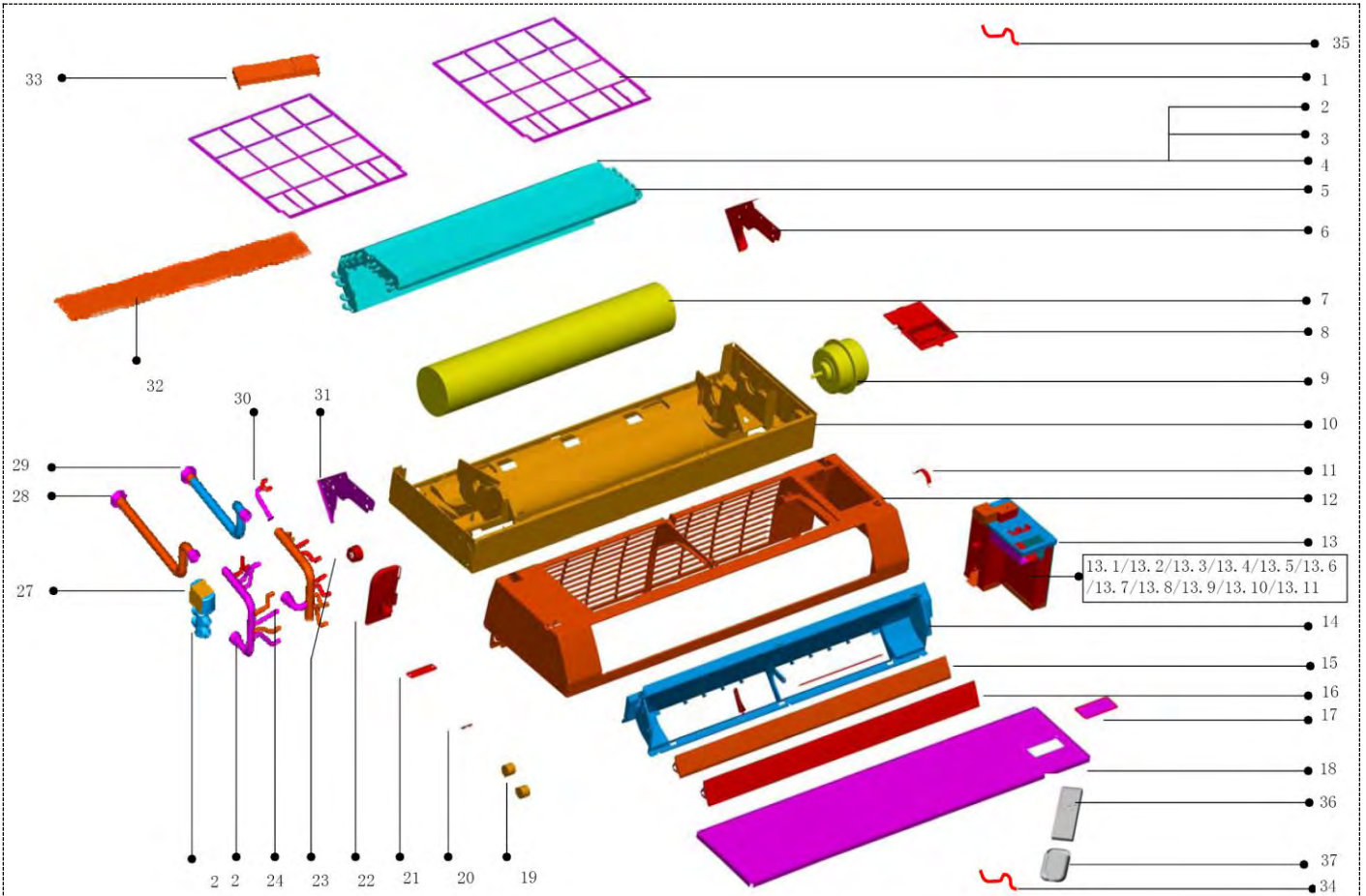

No.	Part Name	Quantity	No.	Part Name	Quantity
1	Filter	2	14	Air outlet frame mount ass'y	1
2	Evaporator I	1	15	Louver board	1
3	Evaporator II	1	16	Louver	1
4	Evaporator III	1	17	Panel dalle	1
5	Coil temp sensor	1	18	Panel	1
6	Evaporate connect board	1	19	Stepper motor	2
7	Cross fan	1	20	Screw cover	3
8	Display board ass'y	1	21	Pipe clamp	1
9	Motor	1	22	Drainage pan	1
10	Base pan assembly	1	23	Bearing base	1
11	Motor spud	2	24	Water inlet pipe ass'y	1
12	Panel frame ass'y	1	25	Water outlet pipe ass'y	1
13	E-part box ass'y	1	26	Three-way valve	1
13.1	Dial code switch box cover	1	27	Control wire for 3-Ways valve	1
13.2	Electric control box seat	1	28	Outlet screw pipe ass'y	1
13.3	E-Part box cover	1	29	Inlet screw pipe ass'y	1
13.4	Electric control box soleplate	1	30	Discharge valve	1
13.5	Electric control box side board ass'y	1	31	Evaporator left clapboard	1
13.6	Dial code switch board ass'y	1	32	Base pan holder	1
13.7	Main controller ass'y	1	33	Formaldehyde killer	1
13.8	Transformer	1	34	Room Temperature Sensor Ass'y	1
13.9	Motor capacitor	1	35	Network matching wire	1
13.10	Wire joint, 3p	1	36	Remote controller	1
13.11	Wire joint	1	37	Remote controller holder ass'y	1

10. Operation Limits

Use the system in the following temperature for safe and effective operation.

Mode	Temperature	water inlet temperature
Cooling operation		3°C~20°C
Heating operating		30°C~70°C
Dry operation		3°C~20°C



Air Conditioning Systems

Cooling & Heating

TRUST AIR-CONDITIONING EQUIPMENT CO.

Shiraz office: 8 th floor, Alvand Bldg., Dostan St.,
Moaliabad Ave., SHIRAZ, IRAN., Post code: 71877-14446

Tel.: +98-71-36341070

Fax.: +98-71-36341094

Tehran office: No. 19- koohe nour St.- Motahhari St.-

TEHRAN, IRAN., Post code: 15876-73111

Tel.: +98-21-89389

Fax.: +98-21-88541903

Ahwaz office: No. 309- Kaveh St.- AHWAZ, IRAN., Post code: 61939-47911

Tel.: +98-61-32230647-8

Fax.: +98-61-32230647

E-mail: info@trustacs.com

Web site: <http://www.trustacs.com>

پرتو پرتو در اولین جشنواره بین المللی
برترین نام و نشان های تجاری ایران

